

CONTENTS

◇ English Instructions	01-04
◇ Deutsches Benutzerhandbuch	05-08
◇ Instrucciones en español	09-12
◇ Istruzione in italiano	13-16
◇ Instructions en français	17-20
◇ Инструкция на русском языке	21-24
◇ 日本語版取説	25-28

[Buttons and Ports]

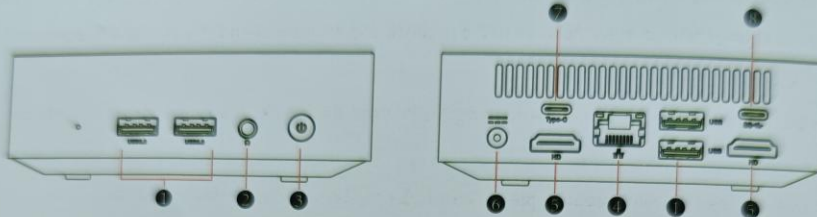

- 1. USB port
- 2. Audio jack (with microphone support)
- 3. Power button

- 4. Ethernet jack
- 5. HDMI port

- 6. DC port
- 7. Type-C
- 8. USB 2.0

[VESA-mount Installation]



VESA-mount bracket

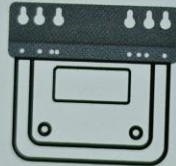

Fix the bracket to the mini PC with screws.



Fix the bracket to the back of the monitor with screws.

⚠ To ensure safety and avoid hazards, we strongly recommend that you use the original power adapter for power supply.

*The specifications are subject to the actual product.

[Precautions for Use]

In order to continuously improve the user experience, we may occasionally update applications and firmware.

- Do not use strong chemical solvents to clean the product, and we recommend you wipe it with a soft cloth.
- Please keep this product away from fire.
- Please do not try to open the case or perform repairs yourself. If a failure occurs, please contact customer service.
- When cleaning the electronic product, please keep it dry and be cautious of electric shocks.
- Please check whether any cables or plugs are worn or damaged.
- Do not dispose of the product carelessly, be mindful to protect the environment.
- Ideal working environment temperature: 10°C-45°C; humidity: 30%-85%.
- Ideal storage environment temperature: -20°C-60°C; humidity: 10%-90%

[RAM and SSD Installation (This operation should be performed when the power is disconnected)]

DDR SDRAM Installation (As shown in the figure)

1. Align the DDR SDRAM module with the RAM slot, then gently push the module into the slot at a 30° angle.
2. Press the module down until the DDR SDRAM is secured by the safety arms at both ends of the RAM slot.



SSD Installation (as illustrated in the picture)

1. Align the plug of the SSD and that of the M.2 slot on the motherboard, then gently push the SSD in.
2. Press the other end down and use screws to fix it in place

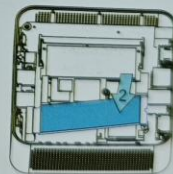

formed when the



[Steps for Connection]



1. Connect the mini PC to the power supply supply

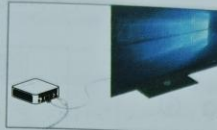

2. Connect the mini PC to the monitor with an HDMI cable

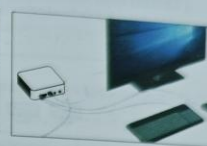

3. Connect the mini PC with a keyboard and a mouse

ly push the SSD in.

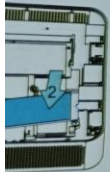

[Switching the Audio Playback Device in Windows]

If your PC is connected to multiple audio playback devices (eg. speakers, headphones, Bluetooth headset, monitors with built-in speakers, etc) simultaneously, you will need to choose one of them for audio playback.

1. Simply click the sound icon in your notification area (also known as the "system tray").

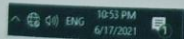

2. Click "Select playback device".



3. Choose a device from the list for audio playback.

