

W2062C DC 12V 24V 10A Intelligent High Precision Digital Temperature Humidity Sensor Controller Red Blue Display

NOTE : If the model you need is AC 110V-220V, you need to buy a transformer, you can buy it directly at the link, thank you! Specification Product model: ZFX-W2062C Product Name: Intelligent high precision digital humidity controller Control humidity range: 1%RH-99%RH Load power: 10A/DC12V/24V Humidity measurement range: 1% RH-999% RH measurement error: plusmn3% RH (good environment temperature is 25deg) Control humidity accuracy: 1% RH display: 1% RH Humidity return: adjustable between 1-50% RH Supply voltage: DC12V/24v Output type: 10A relay output Probe type: humidity resistance sensor Size: 48*29*22mm (long * section * high) Installation hole: 46*27m Moisture control object: dehumidification or humidification Probe line length: 1.5m line length Working environment: humidity 90% RH no frosting Setting instructions Connect the power supply and load to power the controller. The red color above shows the humidity, blue below. Also red) is displayed as the desired humidity, and press STG (+) ENT (-) to set the required humidity. After the setting is completed, wait for 3 seconds to automatically confirm the return. At this time, the controller automatically performs relay energization according to the setting. For 10A relays, to meet high power loads, please make sure the line is correct. Indicator light, digital tube status description Indicator light: off means the relay is off, steady light means the relay is closed Digital tube: The above shows that LL is the sensor open circuit, indicating that HH is out of the measurement range, the humidity will forcibly open the relay. Display - for ultra high humidity protection. Parameter function description Press and hold SET for 5 seconds to enter the main menu settings, press SET (+) ENT (-) to switch P0-P8, when adjusting parameters P0-P8 parameters If you need to adjust P0, press SET button (+) ENT (-) at the same time, adjust OK, then control SET (+) ENT (-) Once confirmed, P1-P8 and P0 set the parameters in each code according to their own needs. Pannel settings:

Size: 48*29*22mm (long * section * high)

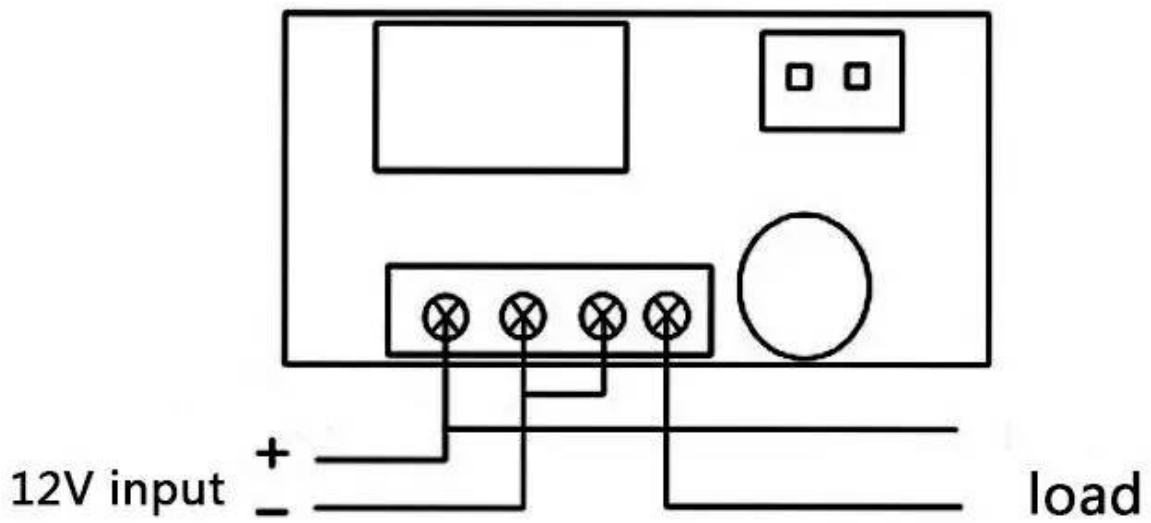

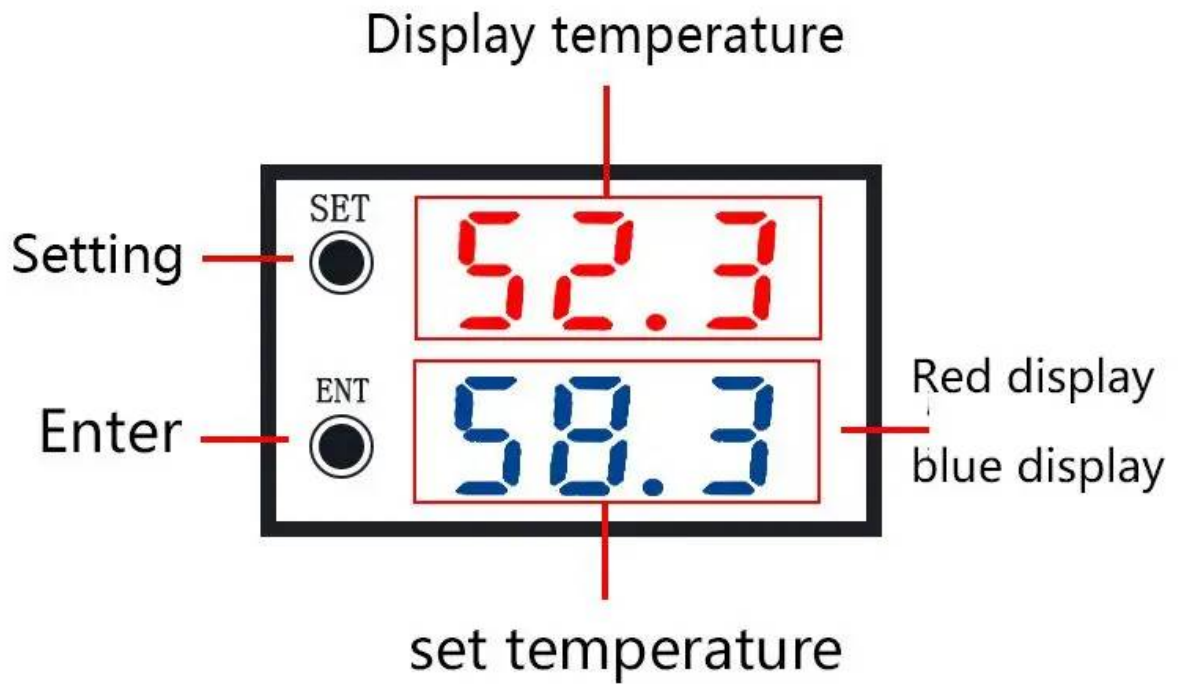

12V /24V















VOKTTA







1.5M
LINE LENGTH

Payment About Payment

- 1) We accept Alipay, West Union, PayPal. TT. All major credit cards are accepted through secure payment processor ESCROW.
- 2) Payment must be made within 3 days of order.
- 3) If you can't checkout immediately after auction close, please wait for a few minutes and retry Payments must be completed within 3 days.



Shipping About Shipping

Shipping Method	Courier	Shipping Time	Tracking Information
Economy Shipping (for order under USD5)	China Post Ordinary Small Packet Plus	About 50-60 days	Not Available
	Yanwen Economic Air Mail		
Standard Shipping (for order over USD5)	China Post Registered Air Mail	About 40-60 days	Available
	Singapore Post	About 20-45 days	
	AliExpress Standard Shipping		
	Epacket		
Express Shipping	DHL Express	About 5-10 days	Available
	EMS Shipping		



Service About Service



Feedback About Feedback

- Item as described ★★★★★ 5 Star
- Communication ★★★★★ 5 Star
- Shipping speed ★★★★★ 5 Star

Your five star feedback will be highly appreciated.

